

LIFE...UNINTERRUPTED™



**PowerStation**  
AUTOMATIC POWER SYSTEM

**P120400 / P120401 / P120410 / P120411**

Models:		Output Standby Rating*			Full Load Current	Motor Starting	Alternator Insulation	MLCB Rating
P120400/P120401 P120410/P120411		Hertz	kW	kVA	Amps	SKVA <sup>(1)</sup>	Class	Amps
Voltage	Phase	60	12LP	12	100/50	20	H	50
120/240	1		10NG					

\*NAMEPLATE RATING FOR CONTINUOUS STANDBY OPERATION FOR THE DURATION OF THE OUTAGE. DERATE 4% PER 1000 FEET ABOVE 500 FEET. (1) RATED @ 30% VOLTAGE DIP.



powered by



**SUBARU**  
HIGH PERFORMANCE ENGINES

## STANDARD FEATURES

### Subaru® Industrial EH72 Engine

- Ultra quiet & dependable V-twin engine
- Specially designed for use on LPG/natural gas
- Oversized (80mm) oil pump and integral oil coolers for lower operating temperature

### 2-Pole Alternator Oversized 14.4kW

- 2/3 pitch winding for reduced harmonics (<5%)
- Simple & reliable self voltage regulated design (± 5%)

### Sound Attenuated Weather Proof Enclosure

- 16 gauge Galvaneel™ (galvanized) steel or 12 gauge aluminum with sound insulating material installed
- Composite mounting pad included for faster installation
- Powder coated almond color finish
- Modular design allows access from all sides

### Fuel System

- Operates on liquefied petroleum gas or natural gas
- Field convertible from natural gas to liquid propane
- Dual 12v D.C. positive lock-off valves for added safety

### Cooling System

- Low maintenance air/oil cooling
- High temperature shutdown protection

### Digital Remote Start/Stop Controller

- Automatic remote start
- Overspeed protection
- Overcrank protection
- Battery condition monitoring
- Underspeed protection
- On-off-auto selector switch
- Engine oil pressure protection
- Hour meter

### Warranty

- 3 year / 1500 hour limited warranty (comprehensive)
- 5 year / 1500 hour extended limited warranty (engine/alternator)

### Accessories

- Engine block heater kit
- Maintenance Kit



SEE REVERSE SIDE FOR TECHNICAL SPECIFICATIONS  
ALL SPECIFICATIONS SUBJECT TO CHANGE WITHOUT NOTICE

## P120400 / P120401 / P120410 / P120411

### ENGINE DATA

<b>General</b>	
Manufacturer	Subaru
Model	EH72
Type	Air cooled, 4-cycle, v-twin cylinder, overhead valve
Horsepower	25.0 / 3600 rpm
Cylinder Block Material	Aluminum
Cylinders	2
Aspiration	Natural
Air Cleaner	Replaceable dual stage
Displacement	720cc
Compression Ratio	8.3:1
Bore	84 mm
Stroke	65 mm
RPM	3600
Engine Governing	+/- 5% - mechanical

<b>Fuel System</b>	
Fuel System	Subaru fuel mixer, secondary regulator, 12V DC positive locking shut-off solenoid
Fuel Type	Liquefied petroleum gas (vapor) or natural gas
Delivery Method	Carburetor induction

<b>Lubrication System</b>	
Lube Oil System	Centrifugal pump, spin-on-full flow filter
Lube Oil Capacity	1.7 quarts
Engine Heater - Optional	120V, thermostatically controlled

<b>Electrical System</b>	
Starting Voltage	12V negative ground
Battery Size Required	BCI group 26, battery rack & 4 gauge cables inc
Cranking Current	450cca @ 0°F
Battery Charging Alternator	30 amps, regulated
Battery Charger (120V AC)	Bulk – 6A, 12V DC absorption – 5.5A, taper to 1.5A between 13-14V DC Float – 0.1 To 0.3A, 13.3vdc K 0.3vdc

### FUEL DATA

Fuel Type	Liquefied petroleum gas vapor or natural gas	
Fuel Supply Inlet	3/4" NPT	
Fuel Supply Pressure	5-11 (In/H <sub>2</sub> O) / 4-6 (Oz/In <sup>2</sup> )	

#### Fuel Consumption

Load	LP Vapor (Gallons/Hour)	Natural Gas (Cubic Feet/Hour)
50%	1.4	103

### SOUND DATA

Less than 70 dB(A) average @ 23' (7m) @ average load

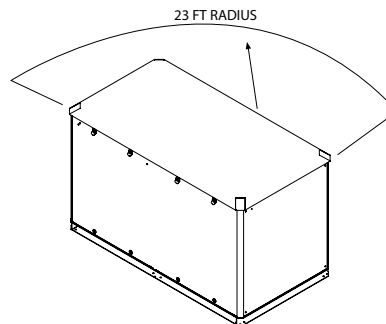

### ENGINE GENERATOR APPLICATION/INSTALL DATA

Engine Cooling Airflow	777 CFM
Alternator Airflow	200 CFM
Total Airflow	977 CFM
Maximum Exhaust Flow	102 CFM
Maximum Exhaust Backpressure	1.5 PSI
Exhaust Temperature	1200 °F

Weight	480 lbs. (P120400) 540 lbs. (P120401) 460 lbs. (P120410) 520 lbs. (P120411)
--------	--

#### Dimensions

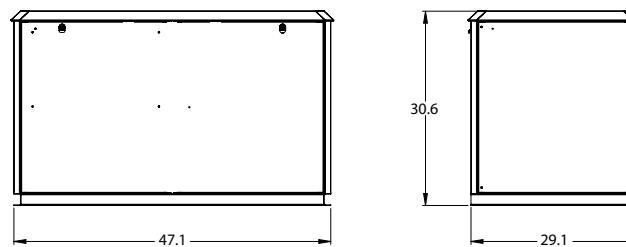

All specifications subject to change without notice



#### Installation Kit (Model P120401 & P120411 Only)

- 100A nema 1 transfer switch
- 10 circuit pre-wired load center expandable to 22 circuits
- Factory pre-wired conduits
- Fault indicator on transfer switch



©2007 POWERMATE CORPORATION. ALL RIGHTS RESERVED.  
POWERSTATION® IS A REGISTERED TRADEMARK OF POWERMATE CORPORATION.

101-3070-1107